

External Corner

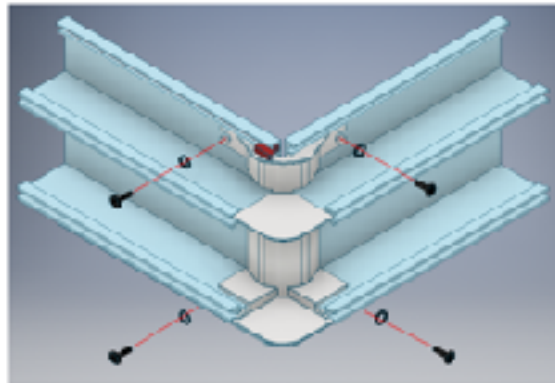

1. The backplate component is initially located into position onto the trunking base with its 2 clip features (highlighted in red) clipping into the outer rail design of the profile. The component is reversible with this feature locating to either the right or left of the apex of the corner – its position should be noted as this determines the orientation of the cover unit when offered to the external corner.
2. Secure the external angle backplate through its ‘horseshoe’ features and the trunking base to the building fabric simultaneously using No 8 round head screws and washers as shown.
3. Single piece external angle mouldings (FDT/EA & FSKT/EA) clip directly onto the base profile on one side and locate underneath the centre compartment profile lid on the other.

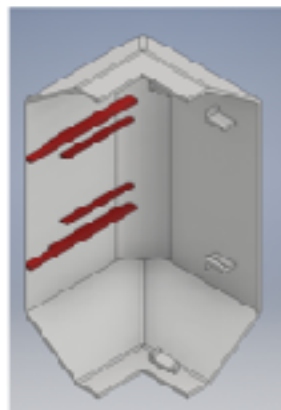

4. Ensure when offering the cover component to the installation that the features highlighted in red are orientated to THE SAME side of the apex of the corner as the backplate clips (also highlighted in red) referenced above at (1). This will allow the 4 clip features on the external angle cover component unobstructed access to the trunking base profile and allow it to seat correctly.